



EAST DELHI MUNICIPAL CORPORATION
(Remunerative Project Cell)

419, Udyog Sadan, First Floor,
Patparganj, Industrial Area,
Delhi-110092.

No. AO (RP Cell)/EDMC/2016/D-257

Dated: 01.09.2016

ADDENDUM

Sub: Addendum in respect of parking NIT No. D-222 dated 11.08.2016.

In reference to this office NIT No. D-222 dated 11.08.2016 vide which bids/tenders were invited for allotment of 50 parking sites in EDMC area, the following **three parking sites** have also been include in the above mentioned NIT as per the details as under:

S. No	Name of parking site/location	Status	MRP	EMD
51.	ABD Block, Dilshad Colony #	Old Site	7,52,000	5,00,000
52.	DDA land, 2 nd Pusta Road, Old Usmanpur Village	New Site	45,000	2,00,000
53.	Near Laxmi Nagar Metro Station adjacent of MCD Primary School	New Site	30,000	2,00,000

The land/site is earmarked for development of school. In future, as and when this land/site is required by the deptt. for development propose, the same will have to be vacated, for which one month vacation notice will be issued.

The other content of the tender document will remain unchanged.

Encl: As above.

Administrative Officer
RP Cell, EDMC

Copy to:

1. Director (IT), Civic Centre, IT Department, MCD with the request to upload the same on MCD/EDMC official website.

Copy for kind information to:

1. PA to Addl. Commissioner-I, EDMC.

Admin. Officer
R.P. Cell
East Delhi Municipal Corporation

Handwritten notes at the top right of the page, including "New Map" and "7/16".

ABD BLOCK DILSHAD COLONY

7/16

Form No. 7/16

New Map

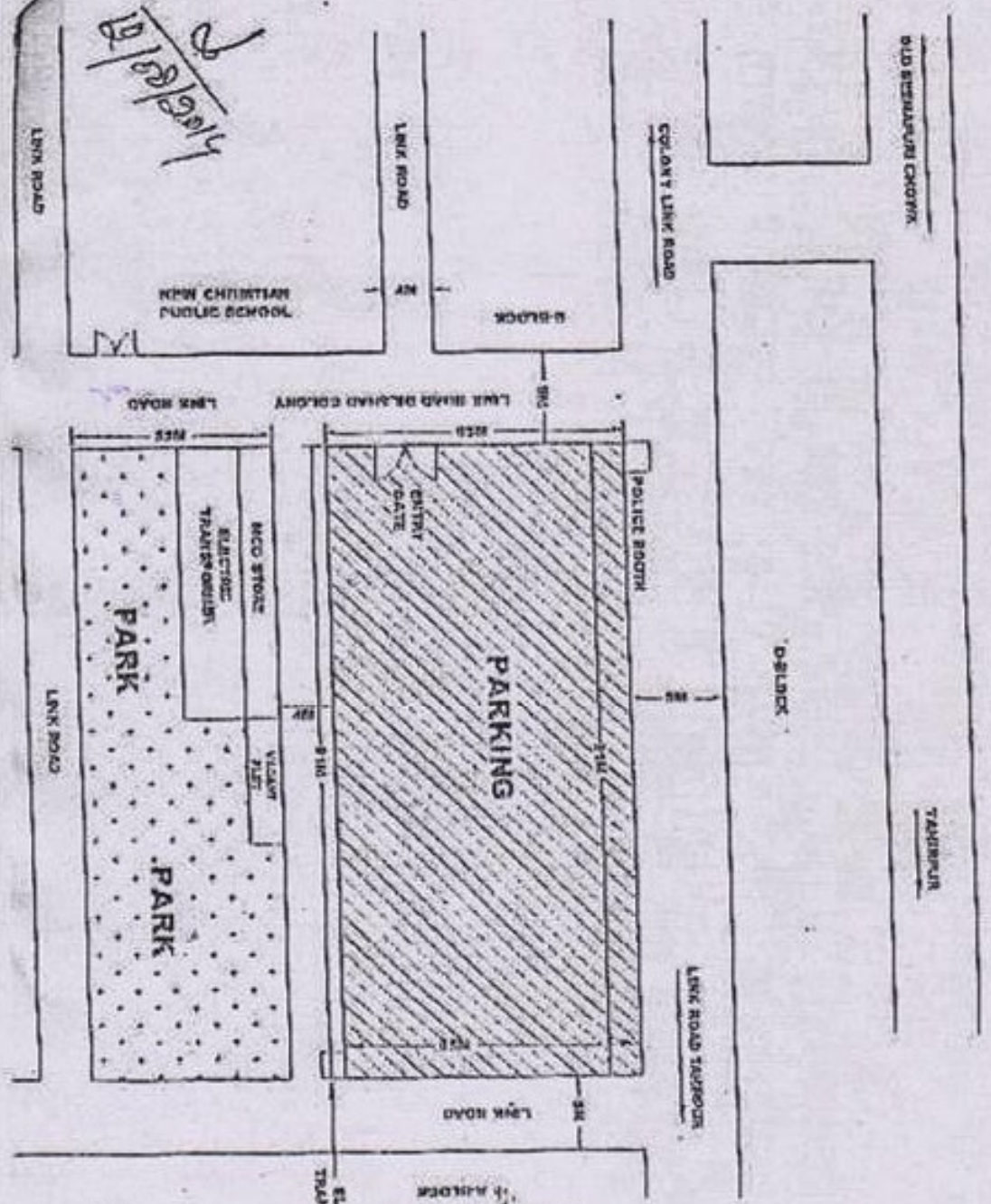

 SURVEYOR
 ENFORCEMENT CELL

 Admin. Officer
 R.P. Cell

PARKING SITE AT 2nd PUSTA OLD USMANPUR VILLAGE

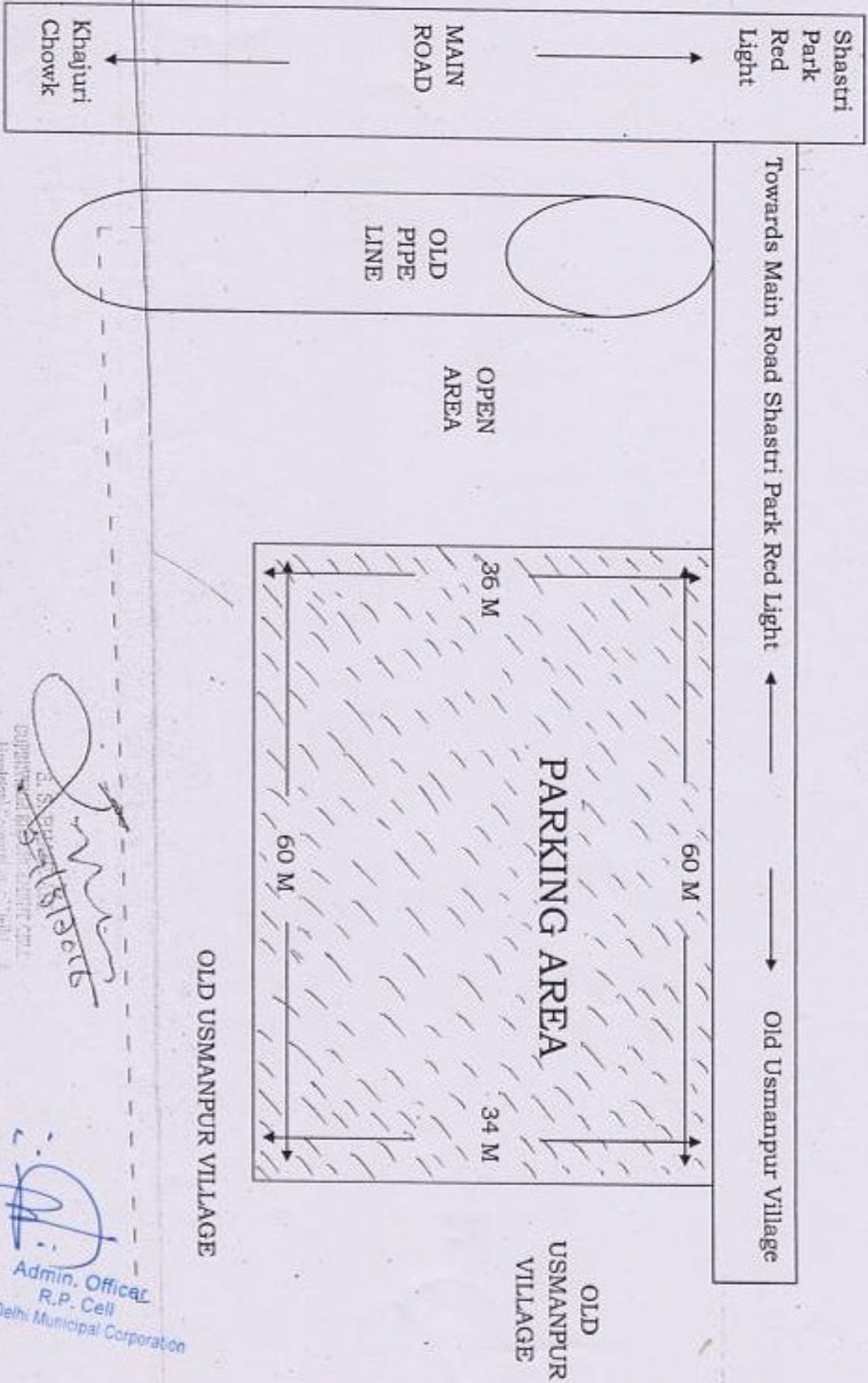

[Handwritten Signature]
SUPERVISOR
Khandari, 2nd Pusta, Old Usmanpur Village

[Handwritten Signature]
Admin. Officer
R.P. Cell
East Delhi Municipal Corporation

**NEAR LAXMI NAGAR METRO STATION
ADJACENT MCD PRIMARY SCHOOL**

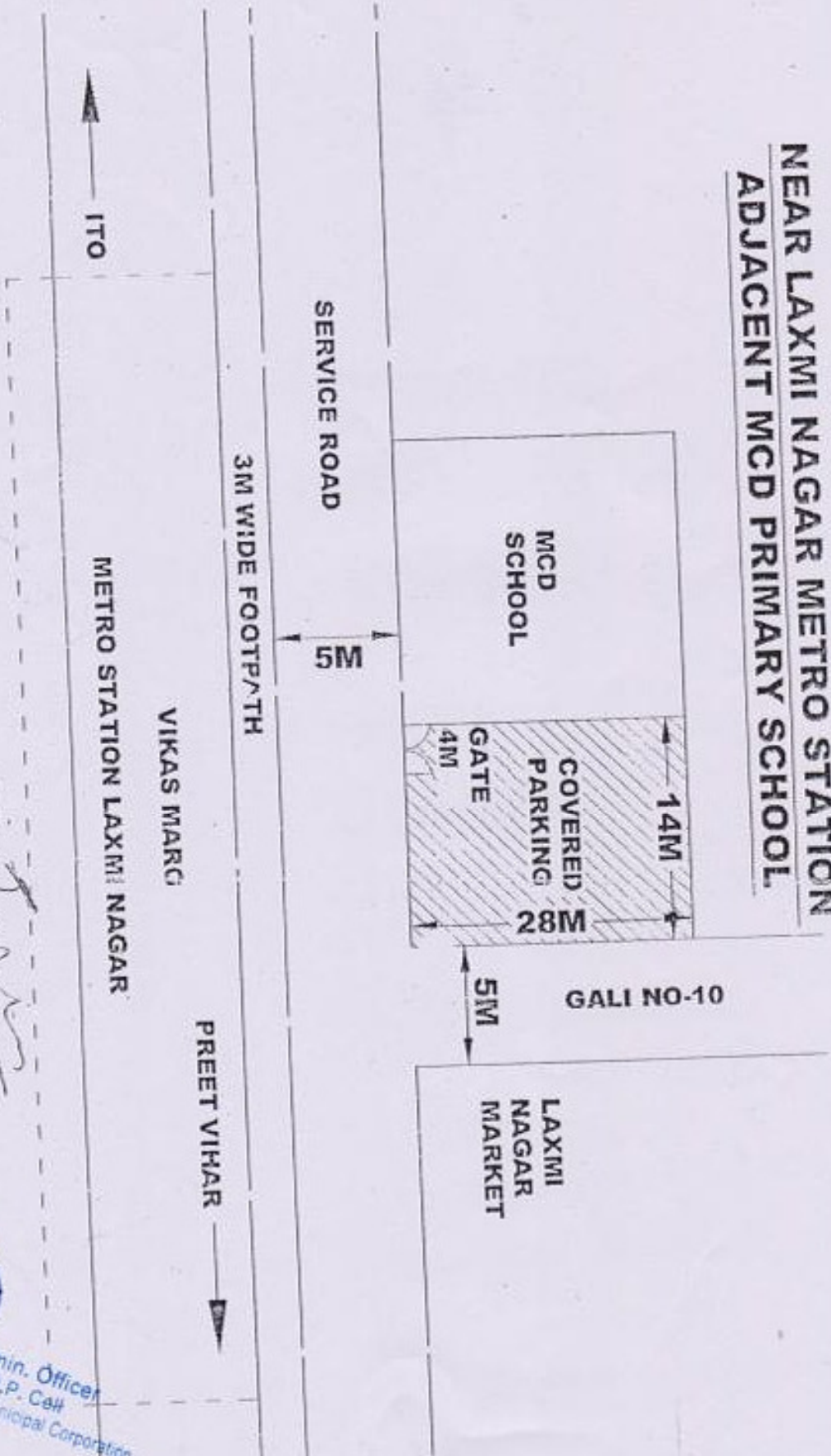

Handwritten signature
5/11/2016

Handwritten signature
Admin. Officer
R.P. Cell
East Delhi Municipal Corporation