



उत्तरी दिल्ली नगर निगम
North Delhi Municipal Corporation



www.nmccplm.gov.in

(Remunerative Project Cell)

16th Floor, Dr.S.P.Mukherjee Civic Centre
Jawaharlal Nehru Marg,
Minto Road, New Delhi-110002
Tel.No.011-23226602/6608

सूचना एवं प्रौद्योगिकी कार्यालय
कायसी संख्या: 6820
दिनांक: 06/08/2018
उत्तरी दिल्ली नगर निगम

No.ADC/RP Cell/NDMC/2018/D-532

Dated: 03.08.2018

ADDENDUM/CORRIGENDUM

In continuation of NIT No.ADC/RP Cell/NDMC/2018/D-131 dated 23.05.2018 and Corrigendum No. ADC/RP Cell/2018/D-219 dated 12.06.2018, ADC/RP Cell/2018/D-435 dated 20.07.2018 and ADC/RP Cell/2018/D-437 dated 23.07.2018 for e-auction to be held on 17.08.2018 uploaded on the North MCD Website for allotment of authorized parking sties falling under the jurisdiction of North DMC as per terms and conditions of Contract already uploaded on website.

The following parking sites be included in the e-auction scheduled to be held on 17.08.2018: -

S. No.	Site No. of NIT	Name of the Parking Site	Zone	MRP	Vehicles allowed	Remarks
1	66	Parking site situated Shastri Park	KBZ	Rs.6,99,800/-	Car/Three Wheeler/Two Wheeler	Map is being uploaded herewith
2	67	Parking site Under Flyover Kirti Nagar	KBZ	Rs.4,19,000/-	Car/Three Wheeler/Two Wheeler	Map is being uploaded herewith

Moreover, Name of Parking Site at S.No.10, the Name of the Parking site and other details may be Read as under: -

S. No.	S.No.of NIT	Name of Parking Sites	Zone	MRP (in Rs.)	Vehicle allowed	Remarks
1	10	Parking site at Mansarover Garden (Part of 8.80 Acre Approx.)	KBZ	Rs.6,38,100/-	Bus/Tempo/Car/ Three Wheeler /Two Wheeler	Amended Auto - CAD Map is being uploaded herewith

In this regard it is hereby requested to upload the corrigendum document on MCD website www.auctionwizard.in/NORTH DMC, www.mcdonline.gov.in and www.mcdonline.gov.in/tri/ndmc MCD portal. The live e- auction will be start on 17.08.2018 from 11.00 Hrs. to 17.30 Hrs.

This issue with the prior approval of Competent Authority.



Addl. Dy. Commissioner
R.P. Adhikari
Cell/North DMC
North D.M.C.

Addl. Director (I.T.)/North DMC

Copy for kind Information to:-

- 1. Addl. Commissioner (Rev.)/North DMC**

R.P. Adhikari
6/8/18

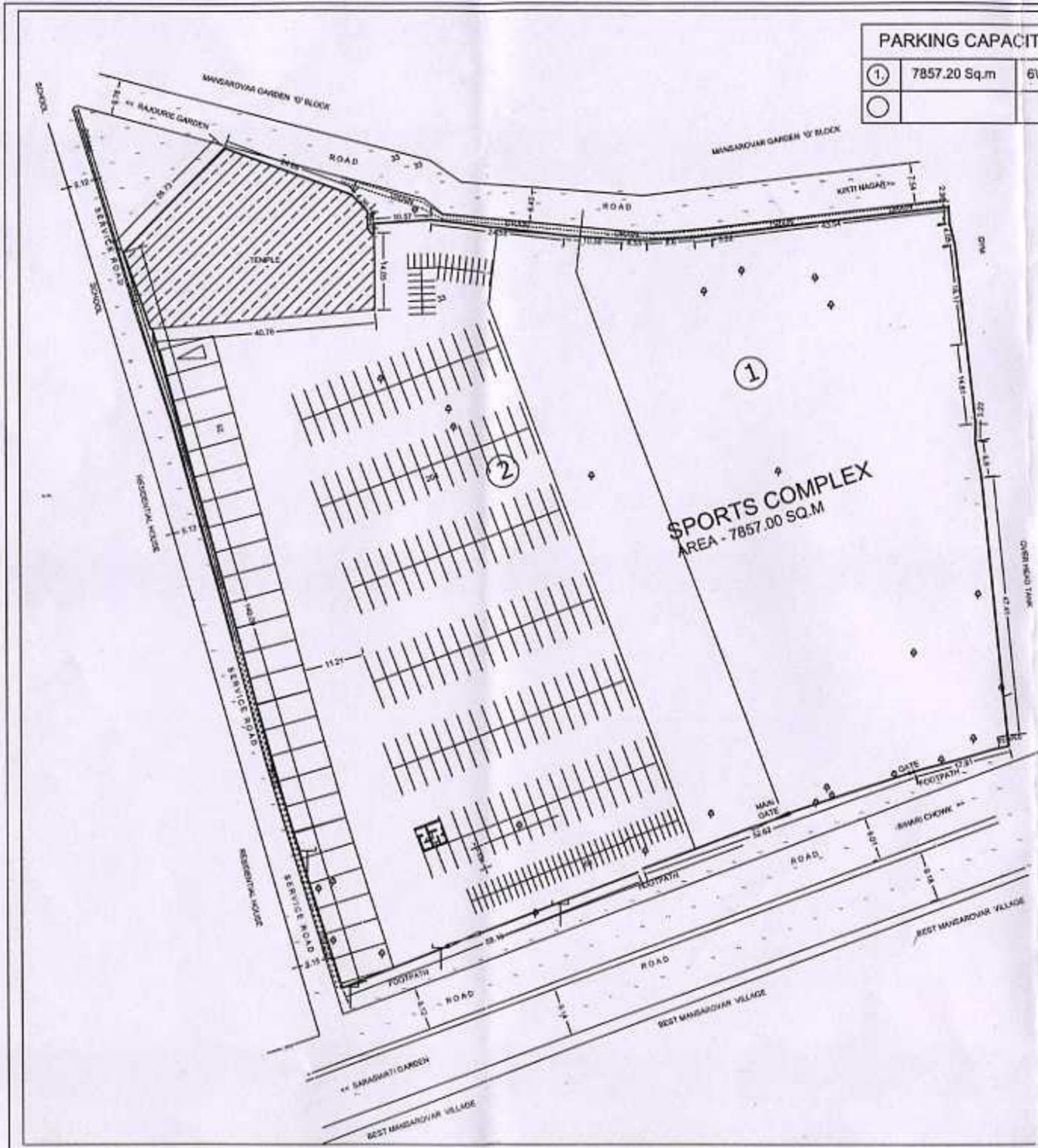

PARKING CAPACITY LOT WISE				
①	7857.20 Sq.m	6W 25	4W 204	2W 101
○				

ITEMS	SYMBOLS
(1) BUILDING	
(2) BOUNDARY WALL	
(3) DRAIN	
(4) GATE	
(5) ROAD	
(6) TREE	
(7) CARS/SCOTTER	



NOTES:-
 OFF-STREET PARKING ARE DENOTED FROM
 ①
 TOTAL 6W 25 4W 204 2W 101
 NO PARKING IN FRONT OF THE MAIN GATE / EXIT.
 GATES OF THE PLOTS OR PREMISES.
 NO PARKING ON THE ISLANDS AND FOOTPATHS.

PROJECT:
**PARKING SITES
 KAROL BAGH ZONE**

TITLE:
**PLAN SHOWING PARKING
 LAY-OUT AT MANSAROVER
 PARK,**

CIVIL CONSULTANTS:
BALAJI CONSULTANTS

ALL DIMENSIONS IN METERS
 DRG. NO:-
2018/BC/KBZ/A-02
 REVISION - "A"

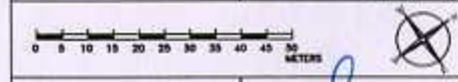

TRANSPORT CONSULTANT

 AO RP CELL

DO RP CELL

 AREA INSPECTOR

Section Officer
 RP Cell
 North Delhi Municipal Corporation
 Civic Centre, Minto Road, N.Delhi



**NORTH DELHI
 MUNICIPAL
 CORPORATION**

Handwritten notes:
 27/8/2018
 V. Prasad K. Sharma
 A.S.O.

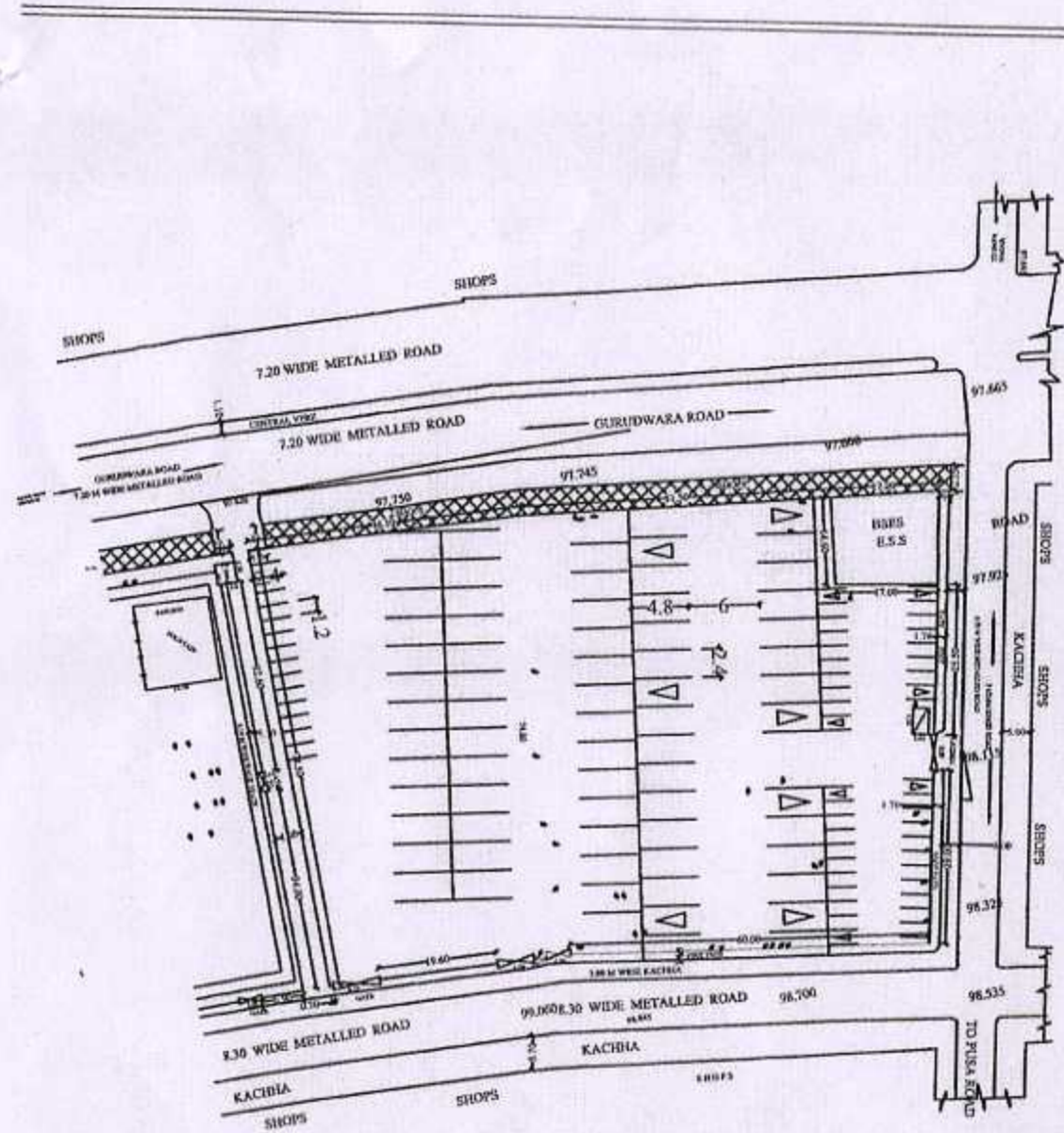

ITEMS	SYMBOLS
(1) BUILDING	
(2) BOUNDARY WALL	
(3) GATE	
(4) ROAD	
(5) TREE	
(6) CAR/SCOOTER	
(7)	

PARKING CAPACITY LOT WISE			
①	1007.00 Sq.m	4W 42	2W 15
②	806.00 Sq.m	4W 28	2W 40



NOTES:-
 STREET PARKING ARE DENOTED FROM
 ① AND ②
 TOTAL 4W 70 2W 55
 NO PARKING IN FRONT OF THE MAIN GATE / EXIT.
 GATES OF THE PLOTS OR PREMISES.
 NO PARKING ON THE ISLANDS AND FOOTPATHS.

PROJECT:
**PARKING SITES
 KAROL BAGH ZONE**

TITLE:
**G.A SHOWING PARKING
 LAY-OUT SHASTRI PARK,
 KAROL BAGH.**

CIVIL CONSULTANTS:
BALAJI CONSULTANTS

ALL DIMENSIONS IN METERS
 DRG. NO:-
2018/BC/KBZ/A-22

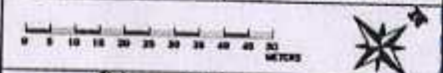

TRANSPORT CONSULTANT
[Signature]
 DO RP CELL

DO RP CELL
 AREA INSPECTOR
[Signature]

**NORTH DELHI
 MUNICIPAL
 CORPORATION**

Section Officer
 RP Cell
 North Delhi Municipal Corporation
 Civic Centre, Minto Road, N.Delhi

[Handwritten signature]
 2/8/18
 R/Cell

15

S.NO 15
D-12

8340

UNDER FLYOVER KIRTI NAGAR

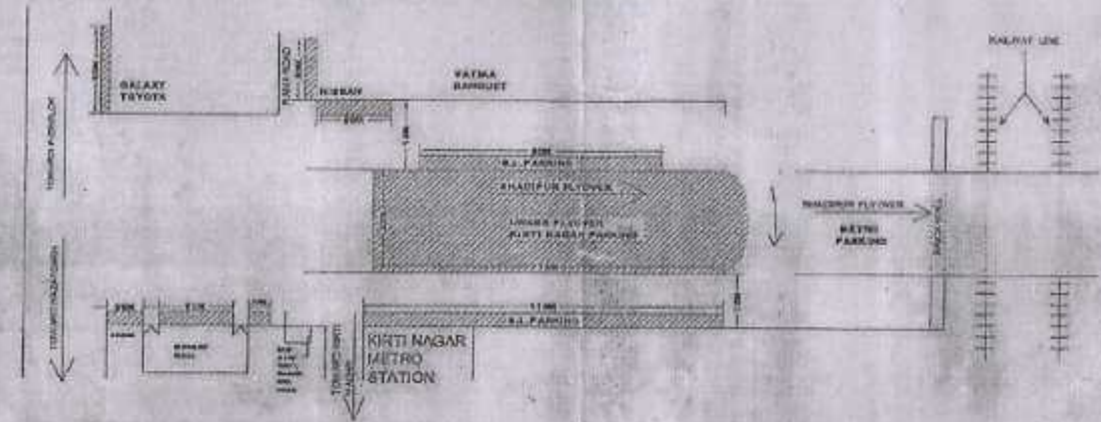

NOTE: HALF LANE PARKING - 2M
 SINGLE LANE PARKING - 4M
 1.5 LANE PARKING - 1.5M
 DOUBLE LANE PARKING - 4M
 CREEPY COVERED PARKING & STRAFTemporary PARKING

3/8/18
3/8/2018
 Vinod Kumar Sharma
 ASO/RP Cell.

Section Officer
 RP Cell
 North Delhi Municipal Corporation
 Civic Centre, Minto Road, N.Delhi

3/8/18
 Superintendent
 RP Cell
 North Delhi Municipal Corporation

16/5/14
 S. S. BRANDARI
 SUPERVISOR'S MANAGEMENT CELL
 Municipal Corporation of Delhi

1:40 SCALE FOR PAVING & STRUCTURE WORK OF UNDER FLYOVER AT KIRTI NAGAR METRO STATION, NORTH DELHI MUNICIPAL CORPORATION